

Bowater Doors  
**Important Information**



Getting the best from your new high-performance door system



## USING YOUR NEW DOOR

To help your new door perform brilliantly, always do the Bowater Doors 1,2,3. Please make sure that everyone in your home is aware of this simple sequence:

- 1. Whenever you close the door, ALWAYS lift the handle fully upwards**

This will engage the advanced Bowater Doors multi-point locking system.

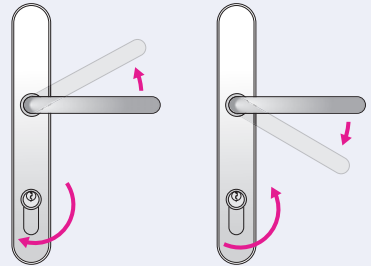

- 2. After lifting the handle, use your key or thumb-turn to deadlock the system**

This ensures you will never forget to give yourself the peace of mind of Bowater Doors multi-point security.



## FOR HELP AND ADVICE

0191 410 6631

[bowaterdoors@birtleygroup.co.uk](mailto:bowaterdoors@birtleygroup.co.uk)

[www.bowaterdoors.co.uk](http://www.bowaterdoors.co.uk)

## USING YOUR NEW DOOR

To help your new door perform brilliantly, always do the Bowater Doors 1,2,3. Please make sure that everyone in your home is aware of this simple sequence:

### 3. Engaging the multi-point system EVERY TIME will keep your new door in perfect alignment

Multi-point engagement compresses your door tightly and evenly against the frame beading. This is vital because:

- A tight fit will conserve maximum energy and help cut your energy bills.
- A tight fit will prevent the door from 'bowing' due to expansion and contraction as temperatures change. If 'bowing' is allowed to occur, bolts may become misaligned, making the multi-point locking action stiff to use.



## SO REMEMBER

Do the Bowater Doors 1,2,3 every time and your door will always be secure and energy efficient – with a locking mechanism that works as smoothly as the day it was fitted.

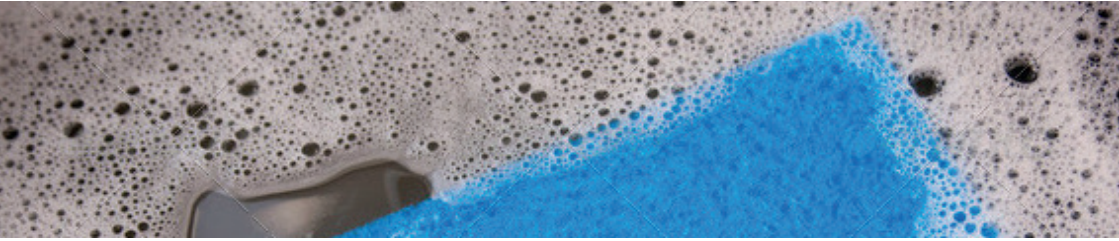

## MAINTAINING YOUR NEW DOOR

All the materials used in your door have been carefully selected to keep their as-new finish and operation year after year. To protect that quality, simply follow this simple guide:

- Wash your door, frame and glass occasionally with warm soapy water
- Dust regularly with a soft cloth
- Be gentle on protective finishes. A number of the components in your door are protected with a special lacquer coating. Never use metal polishes, abrasive cleaners, chemicals or other cleaning solvents on your door, as these can damage the coating
- Lubricate all moving mechanisms with a light oil after installation and at least once a year
- Remember your threshold. This space at the base of your door frame can easily collect dust and debris. It should be cleaned regularly.

